

Note : Probes can be supplied in both configurations as shown below

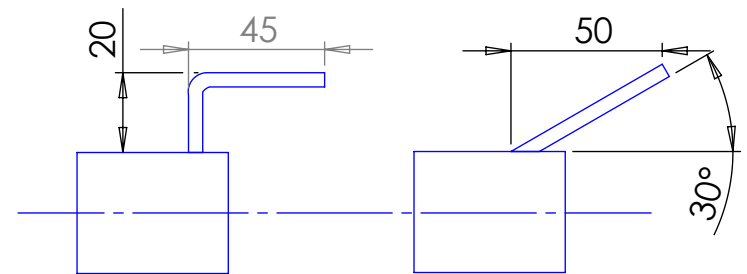

<u>RANGE</u>	<u>BAND</u> $\begin{matrix} \text{---} \text{L} \text{---} \times \text{---} \phi \text{---} \end{matrix}$	<u>LEAD MATERIAL</u>
Min Temp(°C)	30mm x 30mm	PVC
Max Temp.....(°C)	70mm x 30mm	Silicon
	50mm x 40mm	Teflon
	100mm x 40mm	Other.....
<u>SENSOR TYPE</u>	<u>STEM DIAMETER</u>	<u>LEAD</u>
Type K	3mm x	SS Overbraided
Type J	4.5mm x	SS Armour
Other.....	Other	None

SERVOTECH INSTRUMENTATION LTD
 6 WILLIAM PICKERING DRIVE
 ALBANY
 AUCKLAND, NEW ZEALAND
 PHONE: 64-9-415 8362
 FAX: 64-9-415 8361
 EMAIL: sales@servotech.co.nz
 WEBSITE: www.servotech.co.nz



Temperature management by design



TITLE: BAND TYPE THERMOCOUPLE	
DRAWN BY:	DATE:
GENERIC NO. T58	A4
SCALE: NTS	MATERIAL:

UNLESS OTHERWISE SPECIFIED,
 ALL DIMENSIONS ARE IN mm

THIS DRAWING IS EXCLUSIVE
 PROPERTY OF SERVOTECH
 INSTRUMENTATION LTD AND
 SHOULD NOT BE COPIED OR
 HANDED TO OTHER PARTIES
 WITHOUT PRIOR PERMISSION.